

STREAMLINE OPERATIONS & BOOST EFFICIENCY.

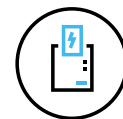

POS printer with a sleek new design, enhanced speed and connectivity.

In the dynamic landscape of modern Retail and F&B environment, Epson's innovative TM-m30III thermal receipt printer is your perfect tool to boost operational efficiency and enhance customer experience. Built with a water-resistant design, the innovative de-curl mechanism aids in flattening paper receipts, adding convenience in daily transactions. The chic and compact printer takes up minimal counter space and provides multiple connectivity options for POS peripherals.



High Speed Printing
(Up to 300mm/sec)



Built-in Bluetooth
and Wi-Fi



Compact



Water
Resistant



Multiple Languages
Support



Designed for
Cloud Printing

ENGINEERED FOR good

IDC Market Opportunity Assessment for Point of Sales Printers in ASEAN, a custom research commissioned by Epson.

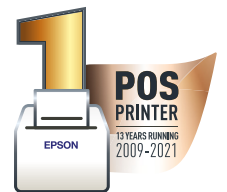

Improved Productivity

Boost efficiency with a swift 300mm/s print speed and Unicode* support for printing in multiple languages.

Advanced Connectivity

Experience built-in Bluetooth and Wi-Fi for versatile connectivity options, and set up tablet POS easily with USB-PD connector.

User-Friendly Operation

Effortless checks with clear indicator and enhanced receipt de-curl mechanism for smoother operation.

*Unicode support is only for languages listed in the specifications sheet.

ALL-PURPOSE MPOS RECEIPT PRINTER

Built for competitive F&B and Retail environments, **Epson's TM-m30III Thermal Receipt Printer** boasts an improved print speed of up to 300mm/s with an enhanced receipt de-curl mechanism, adding efficiency to daily transactions.

User-Friendly Operation

De-Curl Function

The trailblazing de-curl mechanism aids in flattening paper receipts, adding convenience and efficiency in daily transactions.



Clear Indicator Panel

Users can easily and quickly check the printer status and connectivity via the clear indicator panel, troubleshooting any issues promptly.

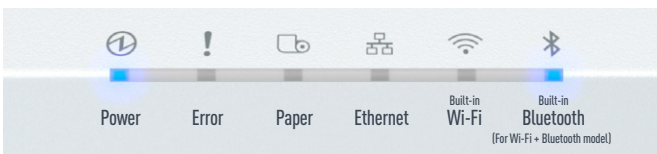

Ergonomic Design

Sleek and Reliable

The newly redesigned TM-m30III boasts a sleek and modern aesthetic, featuring a flat surface that is not only visually appealing but also easy to clean.

Unlike its predecessor, the m30III integrates a cutter built within the printer for added safety, combining style with practicality for a reliable and polished printing solution.



Kitchen-Friendly Design

Designed for wet environments such as kitchens, the TM-m30III is not only water-resistant but also crafted with antibacterial materials. This ensures that the user can effortlessly uphold a clean and hassle-free workspace.



Flexible Placement

Multiple Installation Choices

Perfectly suited for limited spaces, the compact TM-m30III prioritises user convenience through both front and top paper loading options. This versatile design allows for vertical or horizontal placement, adapting to various needs.

For those looking to maximise space efficiency, consider the optional wall mount* for a personalised installation that further enhances adaptability and ease of use.



Space saving design



Vertical wall mount*

*Require the purchase of additional wall hanging unit option.



Hassle-Free Tablet POS Setup

USB-PD Connectivity

The new USB-PD connector enables seamless communication between tablet and printer while ensuring the tablet is fully charged throughout the day.

USB-Network-Thethering

Tablet can both readily transmit data to the TM-m30III and remain fully charged with stable wired connectivity through USB Network Thethering.

Connectivity Options

Experience seamless connectivity with built-in Bluetooth and Wi-Fi, alongside USB and Ethernet options—all in one unit to adapt to diverse setup and environmental needs.

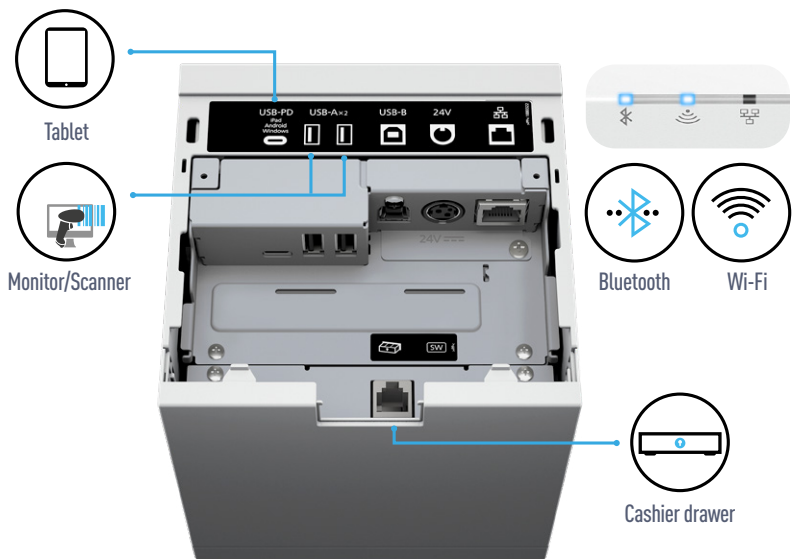

Convenient Tablet Connection

Users can easily and conveniently pair the receipt printer with any tablet via NFC or SimpleAP mode.



Multiple Languages Support

With enhanced Unicode* support, users can seamlessly print multiple languages on a single receipt, eliminating the need for customisation or switching between printers.



*Unicode support is only for languages listed in the specifications sheet.

SPECIFICATIONS

MODEL NUMBER	TM-m30III	TM-m30III
	Standard	Wi-Fi + Bluetooth
Printing Method	Thermal Line Printing	
Print Font		
Font	ANK: 12 x 24 (default) / 10 x 24 / 9 x 17 / ; Kanji Font: 24 x 24 / 20 x 24 (JP) / 16 x 16 (KO)	
Character Set	95 Alphanumeric, 18 International, 128 x 43 Graphic	
Barcode	UPC-A, UPC-E, JAN8 / EAN 8, JAN13 / EAN13, Code39, Code93, Code128 auto, ITF, CODABAR (NW-7), GS1-128, GS1 DataBar 2D Symbol: PDF417, QR code, Maxi Code, Data Matrix, Aztec, Two-dimensional GS1 DataBar, Composite Symbology	
Supported Language	ANK + Thai/Viet + Simplified Chinese + Traditional Chinese + Korean + Japanese (Unicode support*)	
Interface		
Fixed Interface Model	USB B x 1, USB A x2, USB PD x1, Ethernet x1	USB B x1, USB A x2, USB-PD x1, Ethernet x1, Built-in Wi-Fi and Bluetooth 5.0
Receive Data Buffer	4 KB	
Print Speed	300 mm/s	
Dot / Line	576 dots (80mm), 420 dots (58mm)	
Dot / Inch	203 x 203 dpi	
Paper		
Roll Paper	79.5 ± 0.5 (W) × Dia. 83 57.5 ± 0.5 (W) × Dia. 83	
Power		
Operating Voltage	DC + 24 V ± 7 %	
Power Consumption	Operating: 30.6W, Standby: 1.4W	
Operating Temperature	5 - 45° C (41 - 113° F)	
Humidity	10 - 90% RH	
Power Supply	AC Adapter (PS-190)	
Reliability		
Printer Mechanism Life	17 million lines	
Auto Cutter Life	Partial Cut: 2.2 million cuts Full Cut: 1.5 million cuts	
Thermal Printhead Life	150km	
MTBF	360,000 hours	
MCBF	65 million lines	
Colour	Epson Black (EBCK), Epson Ultra White (ENB9)	
Overall Dimensions (W X D X H)	127 x 128 x 130 mm	
Weight	Approx. 2.2 Kg	
General Information		
LED Indicators	Blue LED - Power, Interfaces (Ethernet, Wi-Fi, Bluetooth) Orange LED - Error, Paper Out	
Sensor	Paper End, Paper Near End, Cover Open	
Built-in Features	Server Direct Print, Paper De-Curl	
Printer Driver	Windows Driver (APD), OPOS, OPOS.NET, JavaPOS (Windows, Linux), CUPS Driver (Linux), Mac Driver, TM Virtual Port Driver, TM Bluetooth Connector, ePOS SDK iOS, Android, Javascript)	
Utility Tools	TM Utility (Android, iOS), TM-Print Assistant (Android, iOS), Deployment Tool, Monitoring Tool, TM-m30III Utility	
Easy Setting	NFC	

* Unicode support applicable for languages listed above.

Dimensions & Weight

Weight: Approx. 2.2kg

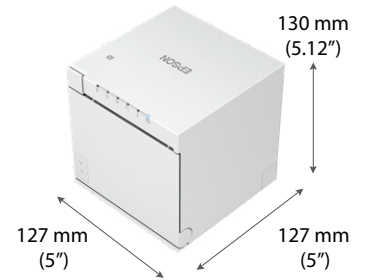
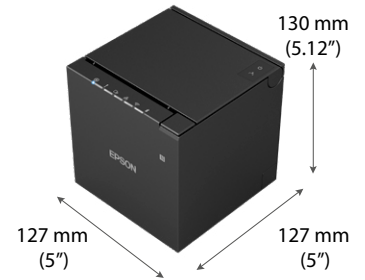

Options & Consumables:

- External Buzzer OT-BZ20
- Wall Hang Unit OT-WH30
- Wireless LAN Dongle OT-WL06
- AC Adapter PS-190
- Customer Display Unit DM-D30

What's in the box:

- AC Adapter PS-190
- AC Cable
- Roll Paper x 1 (for operation check)
- 58mm Paper Guide
- Setup Guide

Legend

dpi dots per 25.4 mm (dots per inch)

©2024 Epson Singapore Pte Ltd. All Rights Reserved. Reproduction in part or in whole, without the written permission from Epson, is strictly prohibited.

EPSON is a registered trademark of Seiko Epson Corporation.

All other product and company names used herein are for identification purposes only and are the trademarks or registered trademarks of their respective owners.

Epson disclaims any and all rights in those marks. Projected images shown herein are simulations. The actual product design and contents may vary. Specifications are subject to change without notice and may vary between countries. Please check with local Epson offices for more information.

Dealer's Stamp

Information correct at time of printing.
Printed January 2024